



MH, CDM
Spot

MH, CDM Spot Light

LFS-08.30

스퀘어 CDM-TC SPOT



White

Specification

Name	LFS-08.30
Size	W130×H130×D124
Lamp	CDM-TC(G8.5) 70W/ 35W
Material	BODY: AL-DIE CASTING REFLECTOR: ALUMINUM COVER: GLASS DRIVER BOX: AL-DIE CASTING, PC

Drawing

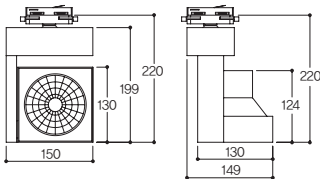

Lamp

CDM-TC

Beam Angle

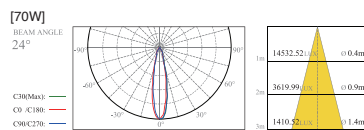
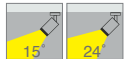

LFS-08.21

플로나 TC SPOT



□ White ■ Black

Specification

Name	LFS-08.21
Size	Ø92×H120
Lamp	CDM-TC(G8.5) 70W/ 35W
Material	BODY: AL-DIE CASTING REFLECTOR: ALUMINUM COVER: GLASS DRIVER BOX: AL-DIE CASTING, PC

Drawing

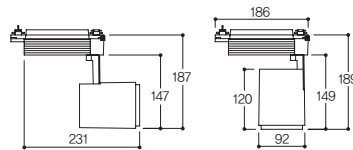

Lamp

CDM-TC



Beam Angle



Distribution curve of luminous intensity

[70W]

BEAM ANGLE
15°

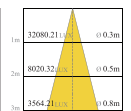

[70W]

BEAM ANGLE
24°

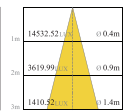

MH, CDM Spot Light

LFS-08.22

알파 CDM-TC SPOT (가로형)



White
 Black

Specification

Name	LFS-08.22
Size	Ø93×H120
Lamp	CDM-TC(G8.5) 70W / 35W
Material	BODY: AL-DIE CASTING REFLECTOR: ALUMINUM COVER: GLASS DRIVER BOX: AL-DIE CASTING, PC

Drawing

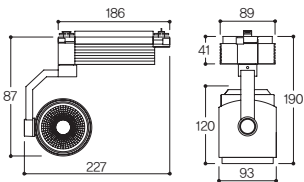

Lamp

CDM-TC



Beam Angle

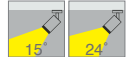

Distribution curve of luminous intensity

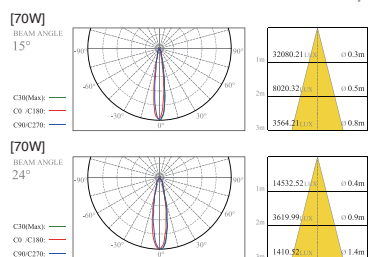

LFS-08.23

알파 CDM-TC SPOT



White
 Black

Specification

Name	LFS-08.23
Size	Ø93×H120
Lamp	CDM-TC(G8.5) 70W / 35W
Material	BODY: AL-DIE CASTING REFLECTOR: ALUMINUM COVER: GLASS DRIVER BOX: AL-DIE CASTING, PC

Drawing

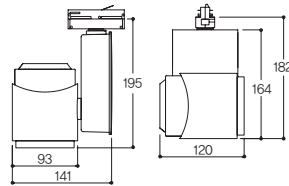

Lamp

CDM-TC



Beam Angle

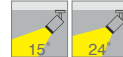

Distribution curve of luminous intensity

[70W]

BEAM ANGLE
15°

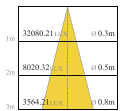
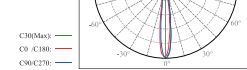

[70W]

BEAM ANGLE
24°

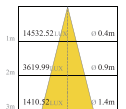
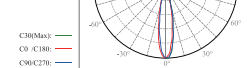

MH, CDM Spot Light

LFS-08.16

미니원 TC SPOT (옆형)



White Black

Specification

Name	LFS-08.16
Size	Ø76×H121
Lamp	CDM-TC(G8.5) 70W/ 35W
Material	BODY: AL-DIE CASTING REFLECTOR: ALUMINUM COVER: GLASS DRIVER BOX: AL-DIE CASTING, PC

Drawing

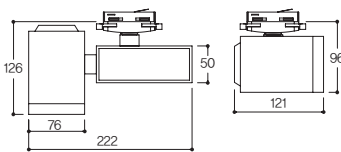

Lamp

CDM-TC



Beam Angle



Distribution curve of luminous intensity

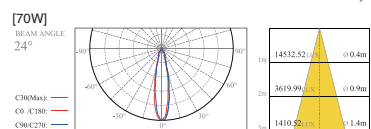

LFS-08.17

미니원 TC SPOT



White
 Black

Specification

Name	LFS-08.17
Size	Ø76×H121
Lamp	CDM-TC(G8.5) 70W/ 35W
Material	BODY: AL-DIE CASTING REFLECTOR: ALUMINUM COVER: GLASS DRIVER BOX: AL-DIE CASTING, PC

Drawing

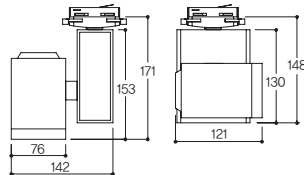

Lamp

CDM-TC



Beam Angle



Distribution curve of luminous intensity

[70W]

BEAM ANGLE

24°

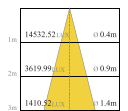
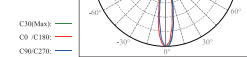

MH, CDM Spot Light

LFS-08.18

콘 T SPOT



(가로형)



(세로형)

White Black

Specification

Name	LFS-08.18
Size	Ø120×H153
Lamp	CDM-T(G12) 70W/ 35W
Material	BODY: AL-DIE CASTING REFLECTOR: ALUMINUM COVER: GLASS DRIVER BOX: AL-DIE CASTING, PC

Drawing

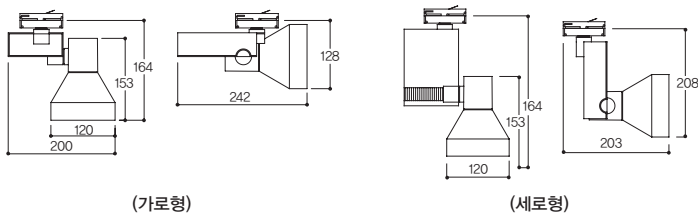

(가로형)

(세로형)

Lamp

CDM-T



Beam Angle



Distribution curve of luminous intensity

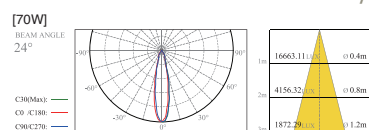

LFS-08.15

샤프원 TC SPOT



White
 Black

Specification

Name	LFS-08.15
Size	Ø93×H125
Lamp	CDM-TC(G8.5) 70W/ 35W
Material	BODY: AL-DIE CASTING REFLECTOR: ALUMINUM COVER: GLASS DRIVER BOX: AL-DIE CASTING, PC

Drawing

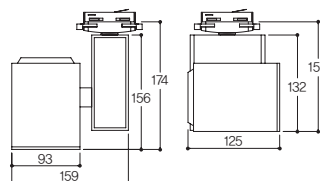

Lamp

CDM-TC



Beam Angle



Distribution curve of luminous intensity

[70W]

BEAM ANGLE
24°

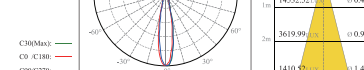

MH, CDM Spot Light

LFS-08.11

나팔 TC SPOT 小



□ White ■ Black

Specification

Name LFS-08.11
Size Ø93×H123
Lamp CDM-T(G8.5) 70W/ 35W
Material **BODY:** AL-DIE CASTING
REFLECTOR: ALUMINUM **COVER:** GLASS
DRIVER BOX: AL-DIE CASTING, PC

Lamp

CDM-TC



Beam Angle



Drawing

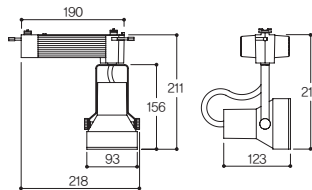

Distribution curve of luminous intensity

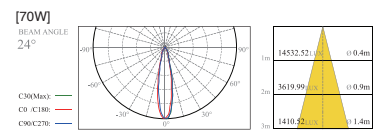

LFS-08.05

나팔 T SPOT 大



□ White ■ Black

Specification

Name LFS-08.05
Size Ø120×H153
Lamp CDM-T(G12) 70W/ 35W
Material **BODY:** AL-DIE CASTING
REFLECTOR: ALUMINUM **COVER:** GLASS
DRIVER BOX: AL-DIE CASTING, PC

Lamp

CDM-T



Beam Angle



Drawing

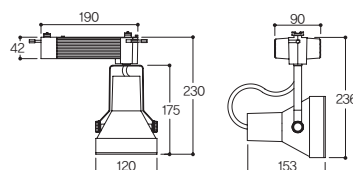

Distribution curve of luminous intensity

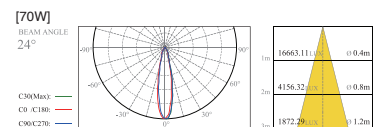

LFS-08.12

원통 TC SPOT 小



White Black

Specification

Name LFS-08.12
Size Ø93 × H127
Lamp CDM-TC(G8.5) 70W/ 35W
Material **BODY:** AL-DIE CASTING
REFLECTOR: ALUMINUM **COVER:** GLASS
DRIVER BOX: AL-DIE CASTING, PC

Lamp

CDM-TC



Beam Angle



Drawing

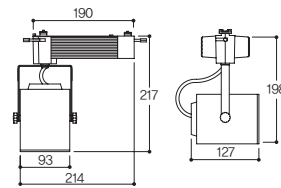

Distribution curve of luminous intensity

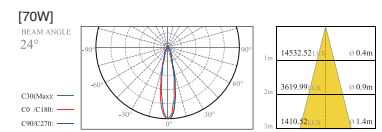

LFS-08.06

원통 T SPOT 大



White Black

Specification

Name LFS-08.06
Size Ø120 × H152
Lamp CDM-T(G12) 70W/ 35W
Material **BODY:** AL-DIE CASTING
REFLECTOR: ALUMINUM **COVER:** GLASS
DRIVER BOX: AL-DIE CASTING, PC

Lamp

CDM-T



Beam Angle



Drawing

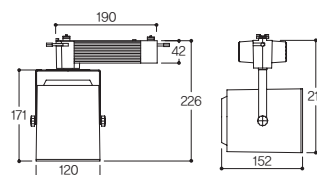

Distribution curve of luminous intensity

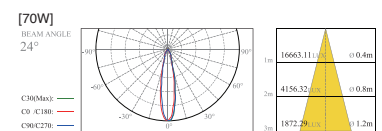

E26 Base Spot Light

LFS-07.22

에스 PAR30 SPOT

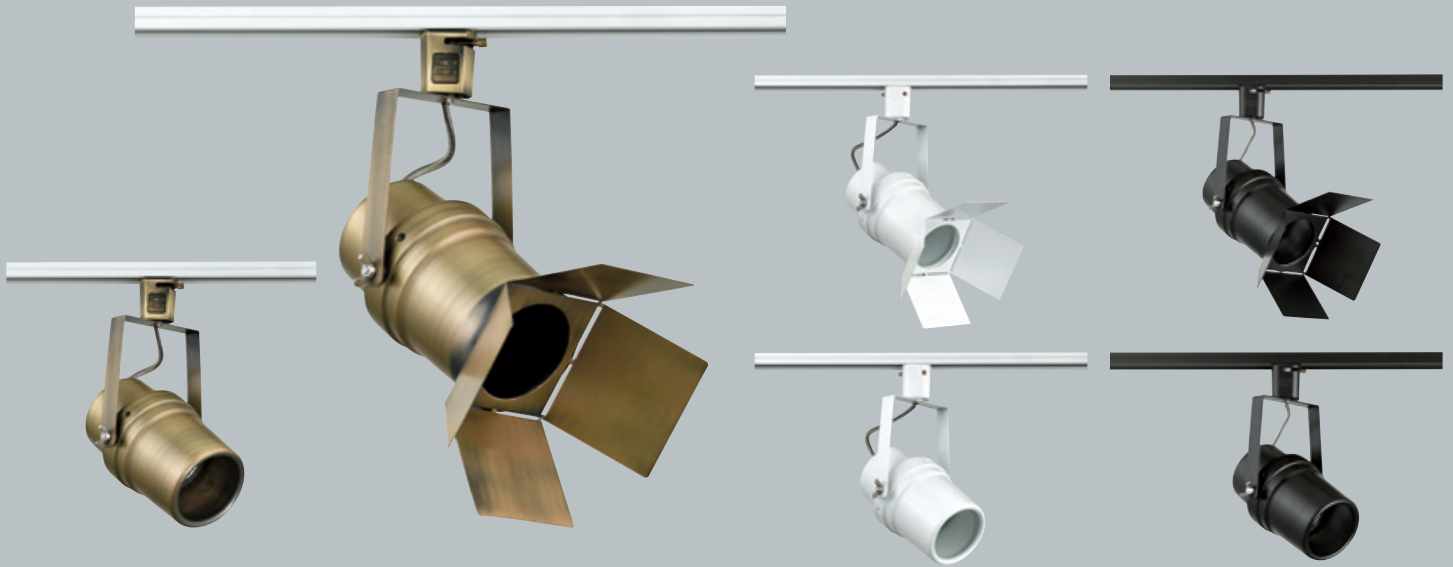

White
 Black
 Bronze

Specification

Name LFS-07.22
Size Ø117×H268
Lamp PAR30(E26) 75W/
 LED PAR30(E26)
Material **BODY:** ALUMINUM, STEEL

Drawing

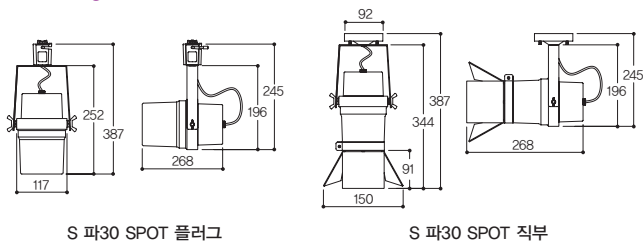

Lamp

PAR30 LED PAR30 Beam Angle



Distribution curve of luminous intensity

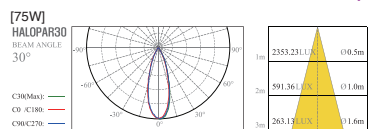

LFS-07.02

메가 자유봉 SPOT

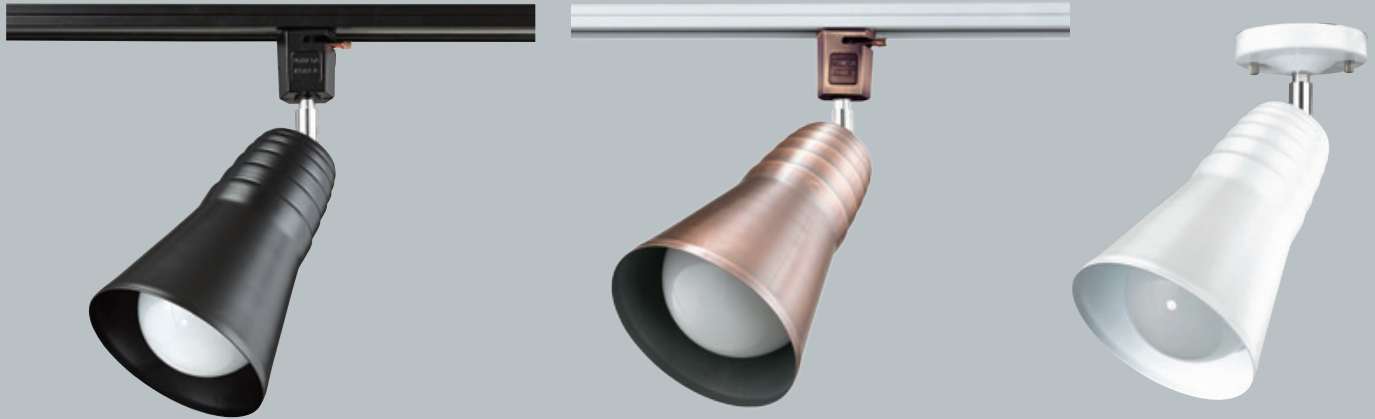

White
 Black
 Bronze

Specification

Name	LFS-07.02
Size	Ø134 × H186
Lamp	EL(E26) IL/ LED IL(E26) PAR30(E26) 75W/ LED PAR30(E26)
Material	BODY: ALUMINUM, STEEL

Drawing

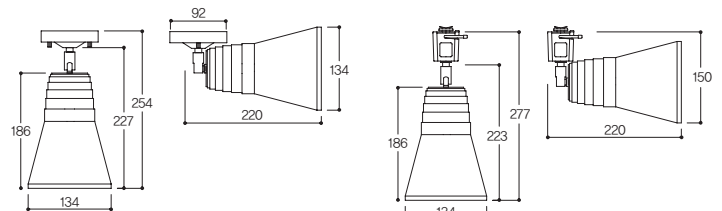

메가 자유봉 SPOT 직부

메가 자유봉 SPOT 플러그

Lamp

EL IL LED IL PAR30 LED PAR30



Beam Angle

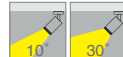

Distribution curve of luminous intensity

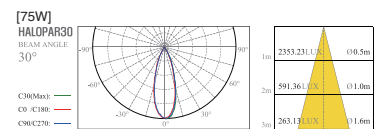

E26 Base Spot Light

LFS-07.10

캐논 PAR30 SPOT



White
 Black
 Chrome

Specification

Name LFS-07.10
Size Ø116×H125
Lamp PAR30(E26) 75W/
 LED PAR30(E26)
Material **BODY: STEEL**

Drawing

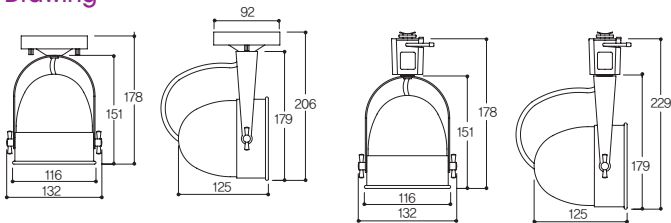

캐논 SPOT 직부

캐논 SPOT 플러그

Lamp

PAR30 LED PAR30 Beam Angle



Distribution curve of luminous intensity

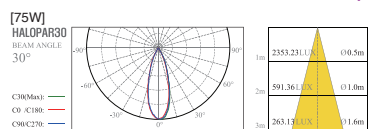

LFS-07.09

도토리 PAR30 SPOT



White
 Black
 Chrome
 Bronze

Specification

Name	LFS-07.09
Size	Ø108 × H121
Lamp	PAR30(E26) 75W/ LED PAR30(E26)
Material	BODY: STEEL

Drawing

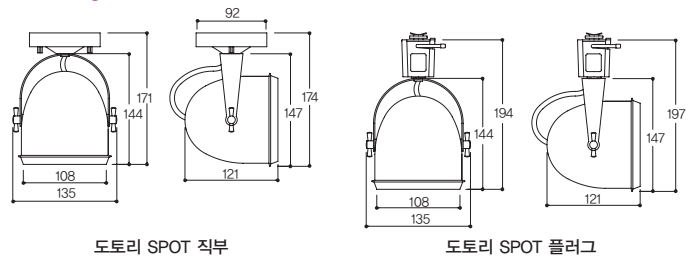

Lamp

PAR30 LED PAR30 Beam Angle

Distribution curve of luminous intensity

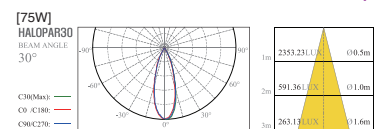

E26 Base Spot Light

LFS-07.12

모던 원통 PAR30 SPOT



□ White ■ Black

Specification

Name	LFS-07.12
Size	Ø106×H135
Lamp	PAR30(E26) 75W/ LED PAR30(E26)
Material	BODY: ALUMINUM, STEEL

Drawing

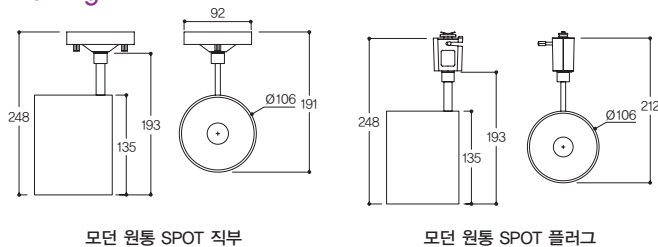

Lamp



Distribution curve of luminous intensity

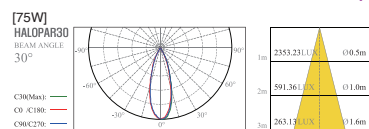

LFS-07.21

써클 PAR20 SPOT



□ White ■ Black

Specification

Name	LFS-07.21
Size	Ø70×H125
Lamp	PAR20(E26) 50W/ LED PAR 20(E26)
Material	BODY: ALUMINUM, STEEL

Drawing

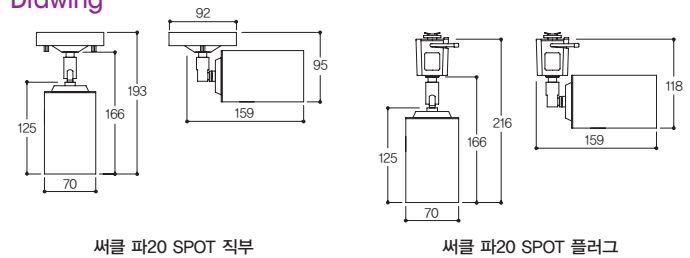

써클 파20 SPOT 직부

써클 파20 SPOT 플러그

Lamp

PAR20 LED PAR20



Beam Angle

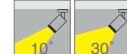

Distribution curve of luminous intensity

[50W]

BEAM ANGLE
24°

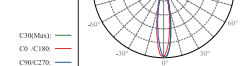

2m	781.75 lux	Ø0.70m
4m	195.44 lux	Ø1.5m
6m	86.86 lux	Ø2.2m
8m	48.86 lux	Ø3.0m
10m	31.27 lux	Ø3.7m
12m	21.72 lux	Ø4.5m



E26 Base Spot Light

LFS-07.13

외발 원통 PAR30 SPOT

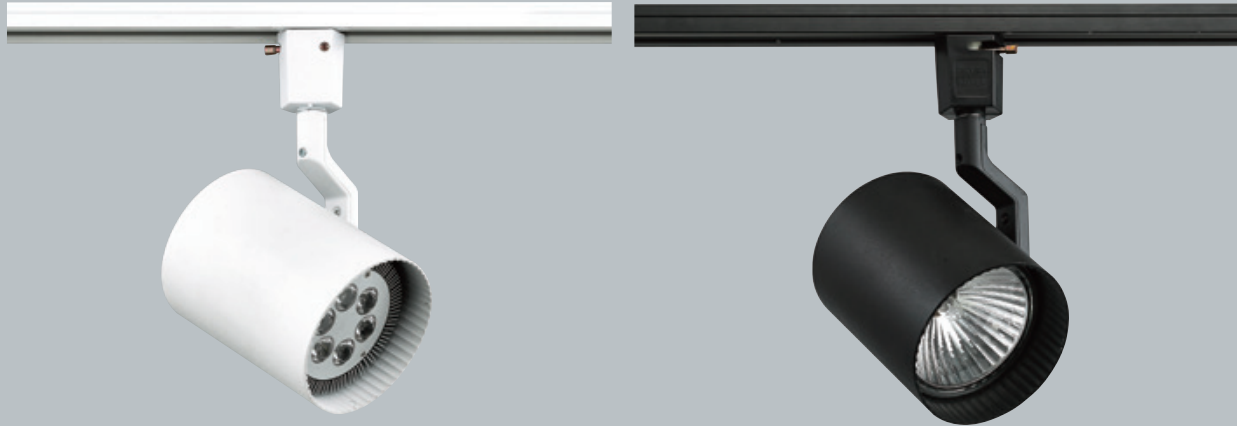

□ White ■ Black

Specification

Name LFS-07.13
Size Ø105×H144
Lamp PAR30(E26) 75W/
 LED PAR30(E26)
Material **BODY:** AL-DIE CASTING, ALUMINUM

Drawing

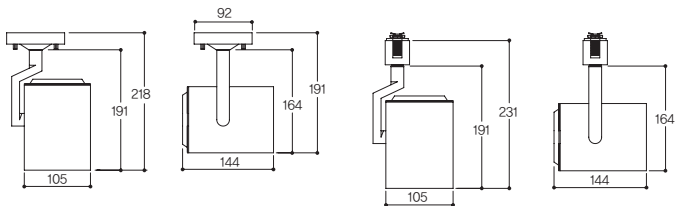

외발 원통 파30 SPOT 직부

외발 원통 파30 SPOT 플러그

Lamp

PAR30 LED PAR30 Beam Angle



Distribution curve of luminous intensity

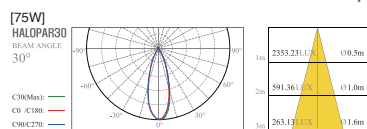

LFS-07.14

외발 원통 PAR20 SPOT



□ White ■ Black

Specification

Name	LFS-07.14
Size	Ø70×H128
Lamp	PAR20(E26) 50W/ LED PAR20(E26)
Material	BODY: AL-DIE CASTING, ALUMINUM

Drawing

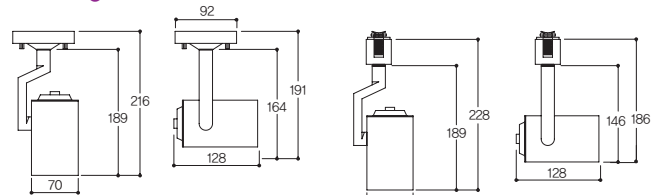

외발 원통 파20 SPOT 직부

외발 원통 파20 SPOT 플러그

Lamp

PAR20 LED PAR20



Beam Angle



Distribution curve of luminous intensity

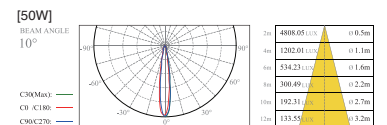

E26 Base Spot Light

LFS-07.01

메가 SPOT



White Black

Specification

Name LFS-07.01
Size Ø134×H186
Lamp EL(E26)
 IL/ LED IL(E26)
 PAR30(E26) 75W/
 LED PAR30(E26)
Material **BODY: STEEL**

Drawing

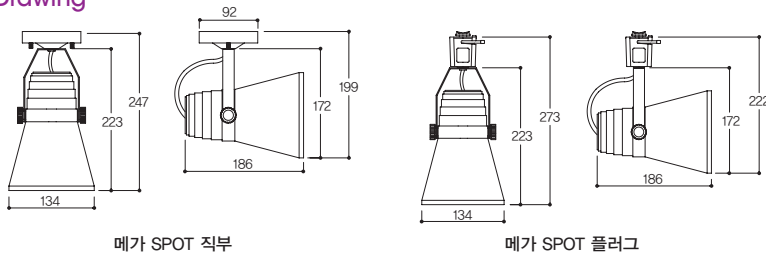

메가 SPOT 직부

메가 SPOT 플러그

Lamp

EL IL LED IL PAR30 LED PAR30



Beam Angle

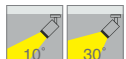

Distribution curve of luminous intensity

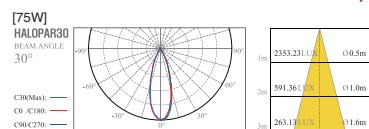

LFS-07.03

나팔 小 SPOT



White
 Black
 Steel

Specification

Name LFS-07.03
Size Ø112 × H123
Lamp EL(E26)
 IL/ LED IL(E26)
 PAR30(E26) 75W/
 LED PAR30(E26)
Material **BODY: STEEL**

Drawing

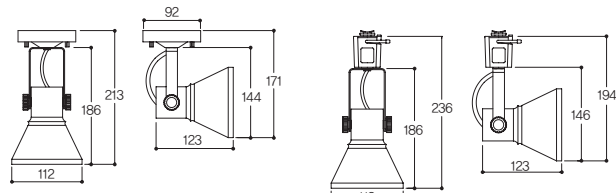

나팔 SPOT 직부

나팔 SPOT 플러그

Lamp

EL IL LED IL PAR30 LED PAR30



Beam Angle



Distribution curve of luminous intensity

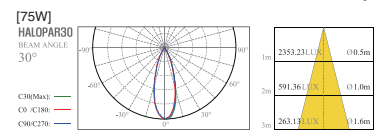

E26 Base Spot Light

LFS-07.04

원통 PAR30 SPOT



White Black

Specification

Name	LFS-07.04
Size	Ø105×H144
Lamp	EL(E26) IL/ LED IL(E26) PAR30(E26) 75W/ LED PAR30(E26)
Material	BODY: ALUMINUM, STEEL

Drawing

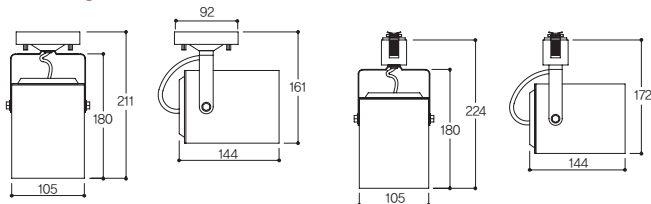

원통 파30 SPOT 직부

원통 파30 SPOT 플러그

Lamp

EL IL LED IL PAR30 LED PAR30



Beam Angle

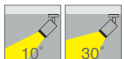

Distribution curve of luminous intensity

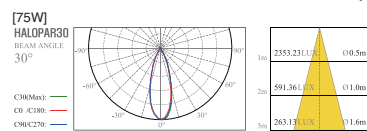

LFS-07.05

원통 PAR20 SPOT



White Black

Specification

Name	LFS-07.05
Size	Ø75 × H136
Lamp	EL(E26) IL/ LED IL(E26) PAR20(E26) 50W
Material	BODY: ALUMINUM, STEEL

Drawing

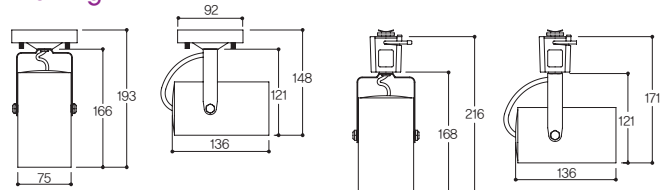

원통 파20 SPOT 직부

원통 파20 SPOT 플러그

Lamp

EL IL LED IL PAR20 LED PAR20



Beam Angle



Distribution curve of luminous intensity

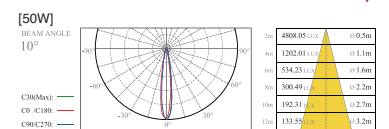

E26 Base Spot Light

LFS-07.06

PAR30 SPOT



□ White ■ Black

Specification

Name	LFS-07.06
Size	Ø108×H130
Lamp	EL(E26) IL/ LED IL(E26) PAR30(E26) 75W/ LED PAR30(E26)
Material	BODY: AL-DIE CASTING, STEEL

Drawing

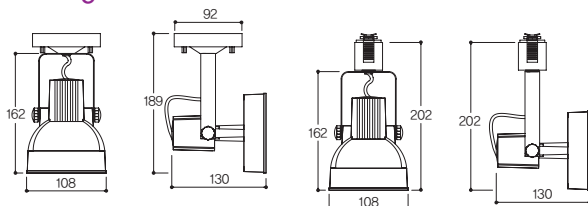

파30 SPOT 직부

파30 SPOT 플러그

Lamp

EL IL LED IL PAR30 LED PAR30



Beam Angle



Distribution curve of luminous intensity

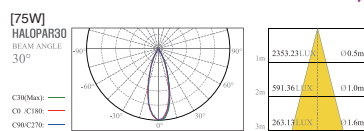

LFS-07.07

차밍 SPOT



White
 Black

Specification

Name	LFS-07.07
Size	Ø63×H96
Lamp	EL(E26) IL/ LED IL(E26) PAR30(E26) 75W/ LED PAR30(E26)
Material	BODY: AL-DIE CASTING, STEEL

Drawing

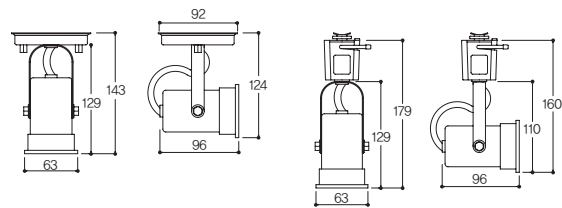

차밍 SPOT 직부

차밍 SPOT 플러그

Lamp

EL IL LED IL PAR30 LED PAR30



Beam Angle

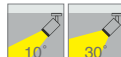

Distribution curve of luminous intensity

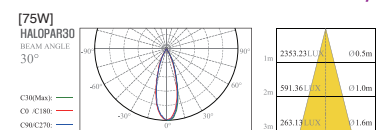

E26 Base Spot Light

LFS-07.08

베스타



White

Specification

Name	LFS-07.08
Size	W227×D41×H94
Lamp	HALOGEN 118mm(RX7s) 200W/ 150W
Material	BODY: ALUMINUM, STEEL

Drawing

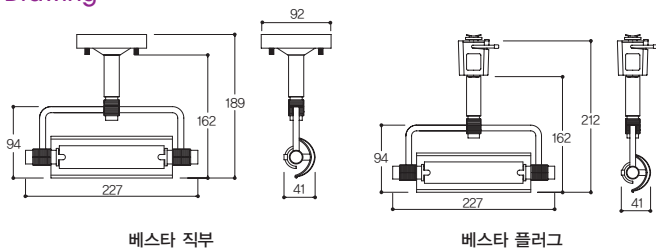

Lamp

HALOGEN



※일부 제품의 사양 및 이미지는 제조사의 사정에 따라 변경될 수 있습니다.
※제품에 대한 문의사항은 제조사에 확인 바랍니다.